



## The Dog & Moon, Derby

ABOUT THE  
OPPORTUNITY

FLOOR PLAN &  
FINISHES

EXTERNAL  
REFURBISHMENT

FIND OUT MORE



## The Dog & Moon Sadler Gate, Derby DE1 3NF

### Why invest?

- **Historic surroundings** – This is a rare opportunity to create a high-quality establishment in the historic centre of Derby, a high-footfall area close to the city's 16th century cathedral.
- **A fresh start** – Along with extensive refurbishment work, the pub's former name, The Shakespeare, will be restored, signifying the change in management and new look.

### Target customers

- The pub will be able to cater to different markets throughout the day, serving groups looking for high quality drinks as well as students and young professionals seeking a higher-energy evening destination.

### Offer

- Food and coffee will drive day trade in an area of Derby known for its café culture.
- Premium craft beers, spirits and cocktails will lead the drinks offer.
- The extensive rear courtyard, with its own bar and covered areas, will offer year-round outdoor space as well as doubling the pub's capacity.



Visuals are for illustrative purposes only. Schemes may vary post completion.

# The Dog & Moon, Derby

ABOUT THE  
OPPORTUNITY

FLOOR PLAN &  
FINISHES

EXTERNAL  
REFURBISHMENT

FIND OUT MORE

[View Bar Moodboard](#)  
[View Lounge Moodboard](#)  
[View Snug Moodboard](#)  
[View Toilets Moodboard](#)

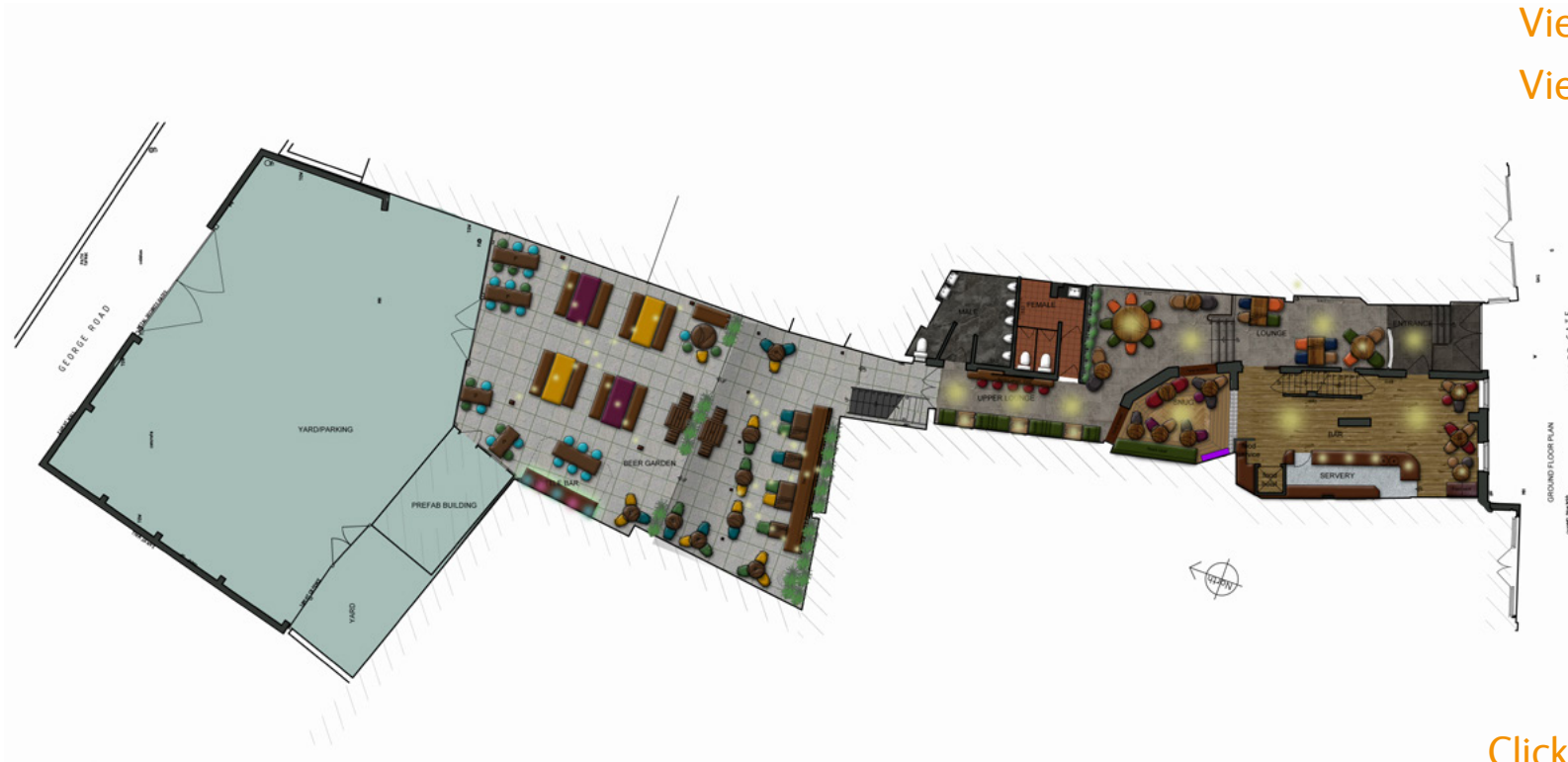

Click on the  to reveal details of the proposed refurbishment.



# The Dog & Moon, Derby

ABOUT THE  
OPPORTUNITY

FLOOR PLAN &  
FINISHES

EXTERNAL  
REFURBISHMENT

FIND OUT MORE

[View Outdoor Moodboard](#)

[View Yard Moodboard](#)



Click on the  to reveal details of the external refurbishment.

Email your enquiry NOW, call us on 08085 94 95 96 or visit [www.starpubs.co.uk](http://www.starpubs.co.uk)

# The Dog & Moon, Derby

ABOUT THE  
OPPORTUNITY

FLOOR PLAN &  
FINISHES

EXTERNAL  
REFURBISHMENT

FIND OUT MORE



**The Dog & Moon is a well-known pub occupying a 300-year old building in the heart of Derby.**

This is a unique opportunity to transform it into a premium destination with a high-quality food and drink offer that will appeal to a range of demographics.

**Interested? Call us today.**

Call on 08085 94 95 96

Or follow the simple online application process at [www.starpubs.co.uk](http://www.starpubs.co.uk)

# The Dog & Moon, Derby

## Schedule for The Dog & Moon

### Bar

Works to the main bar area of the pub will include the following:

- Distressed paint finish to existing panelling
- Food hoist up to first floor kitchen and food service area
- Poseur-height fixed seating
- New cladding to bar front

### Snug

Works to the snug will include the following:

- Dining-height fixed seating
- Timber flooring border with herringbone inset
- New screens to existing windows
- Feature floor tiles

### Lounge

Works to the lounge area of the pub will include the following:

- New feature wall and suspended feature below skylight
- Two-person booths and drinks shelf

### Toilets

Works to the toilets will include the following:

- New tiled floors and full height wall tiles
- New cubicles, sanitaryware and lighting

### Outside area

Works to the outside area will include the following:

- New bottle bar and counter
- New planters
- 58 covers including some covered seating

### Signage and lighting

- New signage reflecting change to original name
- Hanging sign and A-board